



Description: Round recessed LED downlight with direct light.

Body: body in die-cast aluminum, painted white with epoxy powders UV stabilized, thermosetting at 180 ° C, after degreasing treatment, phosphating and washing. The device is supplied complete with brackets for fixing to the countertop.

Optical group: internal reflector in metallized aluminum and **POL** diffuser in opal polycarbonate. Glow-wire test 850 ° C. Protection degree **IP44 / 20** (IP44 on the visible part, IP20 on the embedded part).

Wiring: power supply 220-240V 50 / 60Hz with rigid cable, sect. 0.50 mm² and PVCHT sheath resistant to 90 ° C according to CEI 20-20 standards. Insulation class II. Suitable for installation on normally flammable surfaces.

- LED version with fixed output electronic driver for independent use, included
 - DALI LED dimmable version, with standard digital dimmable electronic driver DALI for independent use, included.
- On request available:
- Versions with 1/3 hour autonomy emergency kit.

Luminous source: High efficiency LEDs arranged on rigid modules, color rendering CRI > 80 (CRI > 90 available on request), color temperature 3000K or 4000K (LED diode selected 3 MacAdam ellipses in order to guarantee uniform chromaticity), duration > 50000 hours L80 / F10 at Ta = 25 ° C.



Demonstration image

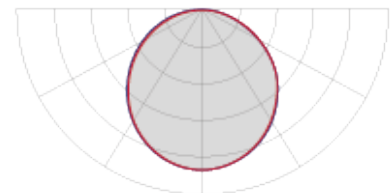

Photometric curve

Regulations: appliance complies with the following standards:

- | | | |
|-----------------|------------------|----------------|
| • EN 61547 | • IEC/TR 62471-2 | • EN 60598-2-2 |
| • EN 55015 | • EN 60061-1 | • EN 62471 |
| • EN 61000-3-2 | • EN 62031 | • EN 62560 |
| • EN 61000-3-3 | • EN 62493 | • EN 60968 |
| • EN 61347-1 | • EN 60598-1 | • CEI 76-10 |
| • EN 61347-2-13 | • EN 60598-2-1 | • EN 60529 |
| | | • |

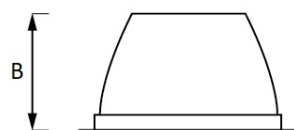
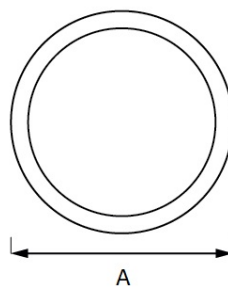



Diameter 120 mm						Dimensions [mm]			Code / Wiring	
Power [W]	Color temperature [K]	CRI	Effective flux [lm] *	Efficiency [lm/W]	Energetic class	A	B	Ø recessed	LED	LED DALI
15	3000K	>80	1418	94	A++	120	70	105	575000060	575000061
15	4000K	>80	1476	98	A++	120	70	105	575000066	575000067
20	3000K	>80	1976	98	A++	120	70	105	575000062	575000063
20	4000K	>80	2059	102	A++	120	70	105	575000068	575000069
28	3000K	>80	2689	96	A++	120	70	105	575000064	575000065
28	4000K	>80	2801	100	A++	120	70	105	575000070	575000071

Diameter 160 mm						Dimensions [mm]			Code / Wiring	
Power [W]	Color temperature [K]	CRI	Effective flux [lm] *	Efficiency [lm/W]	Energetic class	A	B	Ø recessed	LED	LED DALI
20	3000K	>80	1976	98	A++	160	100	148	575000072	575000073
20	4000K	>80	2059	102	A++	160	100	148	575000078	575000079
28	3000K	>80	2689	96	A++	160	100	148	575000074	575000075
28	4000K	>80	2801	100	A++	160	100	148	575000080	575000081
35	3000K	>80	3362	96	A++	160	100	148	575000076	575000077
35	4000K	>80	3506	100	A++	160	100	148	575000082	575000083

Diameter 205 mm						Dimensions [mm]			Code / Wiring	
Power [W]	Color temperature [K]	CRI	Effective flux [lm] *	Efficiency [lm/W]	Energetic class	A	B	Ø recessed	LED	LED DALI
20	3000K	>80	1976	98	A++	205	100	188	575000084	575000085
20	4000K	>80	2059	102	A++	205	100	188	575000090	575000091
28	3000K	>80	2689	96	A++	205	100	188	575000086	575000087
28	4000K	>80	2801	100	A++	205	100	188	575000092	575000093
42	3000K	>80	3845	91	A++	205	100	188	575000088	575000089
42	4000K	>80	4003	95	A++	205	100	188	575000094	575000095

Diameter 230 mm						Dimensions [mm]			Code / Wiring	
Power [W]	Color temperature [K]	CRI	Effective flux [lm] *	Efficiency [lm/W]	Energetic class	A	B	Ø recessed	LED	LED DALI
20	3000K	>80	1976	98	A++	230	117	218	575000096	575000097
20	4000K	>80	2059	102	A++	230	117	218	575000102	575000103
28	3000K	>80	2689	96	A++	230	117	218	575000098	575000099
28	4000K	>80	2801	100	A++	230	117	218	575000104	575000105
42	3000K	>80	3845	91	A++	230	117	218	575000100	575000101
42	4000K	>80	4003	95	A++	230	117	218	575000106	575000107
50	3000K	>80	4529	90	A++	230	117	218	575000108	575000109
50	4000K	>80	4723	94	A++	230	117	218	575000110	575000111

* Actual flow may have a tolerance of ± 10%.